

June 29, 2015

Hopkins County Judge
The Honorable Robert Newsom
PO Box 288
Sulphur Springs, Texas 75483

Farmers Electric Cooperative Member: Billy D. Harris
Service Order Number: 1506003380

The Honorable Judge Newsom,

Farmers Electric Cooperative, Inc. is requesting permission to re-route existing electrical power distribution facilities across CR 3551, which is located approximately .19 miles North of CR 3344, in Hopkins County, Texas.

Site location map and construction sketches are enclosed. The construction sketch details the proposed work. All road crossing will have a minimum vertical clearance of 22 feet.

If you have any questions, please contact field engineering representative Peter Benninger Office 903-453-0513 or mobile 903-453-5292.

Sincerely,
Peter Benninger
Engineering Assistant
pbenninger@farmersselectric.coop

Enclosures

Submitted by:
Ra'chel Tidwell
Field Engineering Coordinator
Office 903-453-0563 Fax **903-453-0663**
rtidwell@farmersselectric.coop

Farmers Electric Cooperative SO#1506003380-Harris
Location of proposed crossing of Hopkins CR 3551
approximately .19 mile south of CR 3344 in Hopkins
Co.

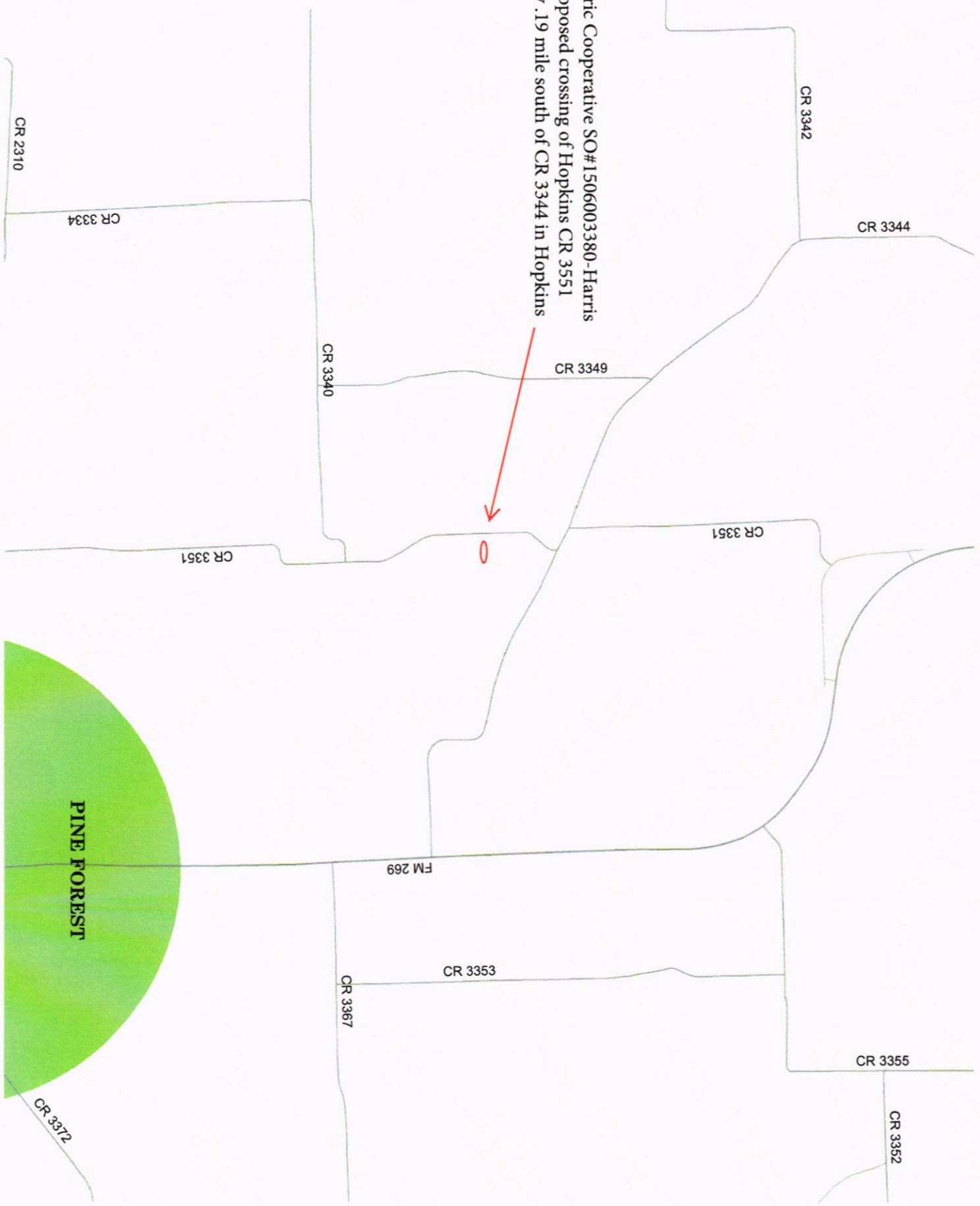



Farmers Electric Cooperative
SO#1506003380-Harris
location of proposed crossing of Hopkins
CR 3551 approximately .19 mile south of
CR 3344 in Hopkins Co.

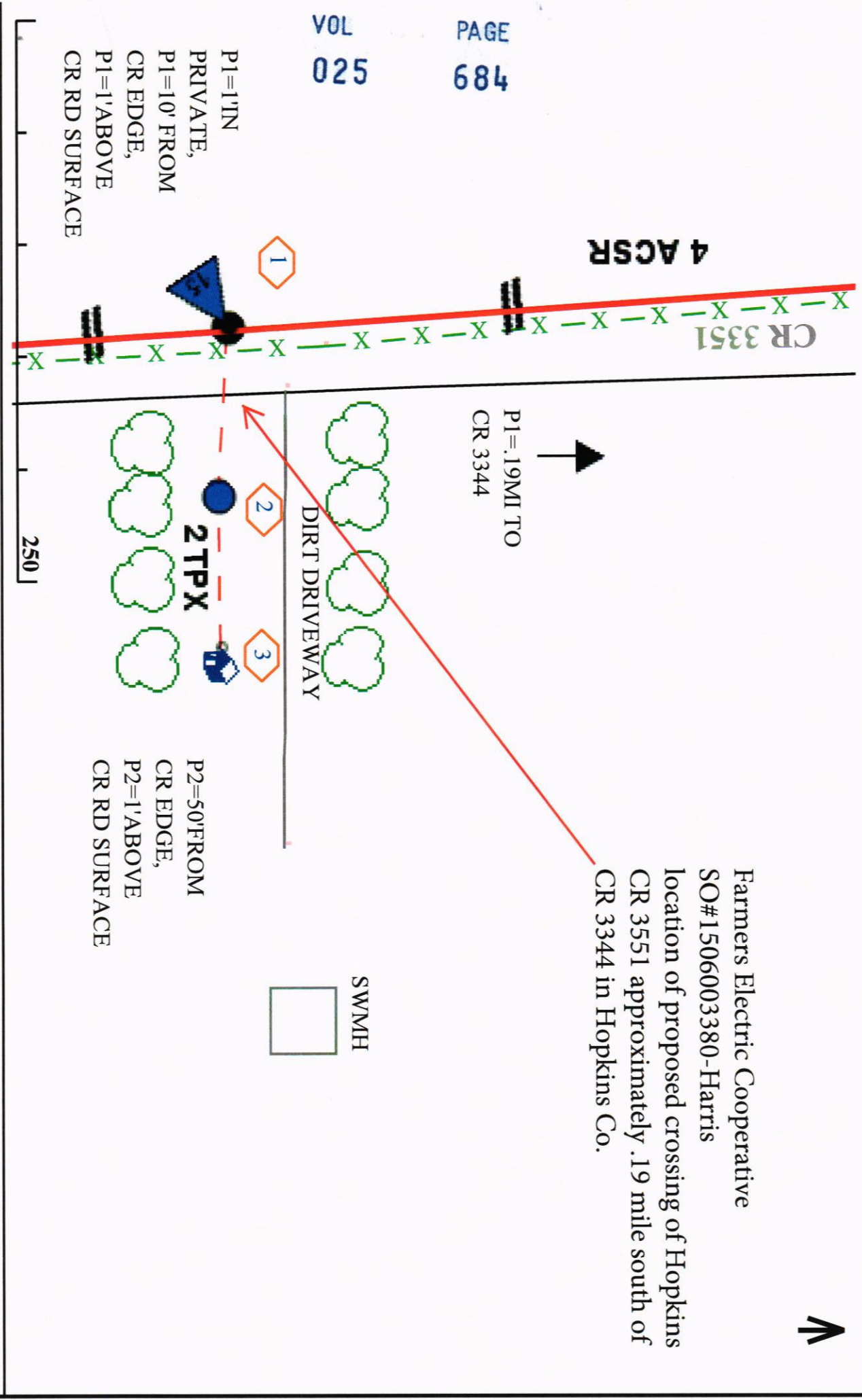

P1=1'IN
PRIVATE,
P1=10' FROM
CR EDGE,
P1=1'ABOVE
CR RD SURFACE

P1=.19MI TO
CR 3344

P2=50'FROM
CR EDGE,
P2=1'ABOVE
CR RD SURFACE

250 |